

QCO-034031-47/-52/-66/-SW

Model	QCO-034031-47/-52/-SW	QCO-034031-66
Voltage	24V DC	24V DC
Power Consumption	3.4 W	3.6 W
Mass	150 g	150 g

Third Angle Projection All dimensions in mm

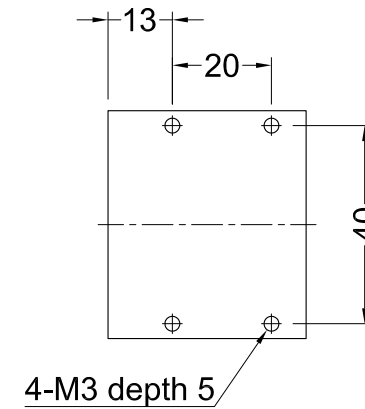
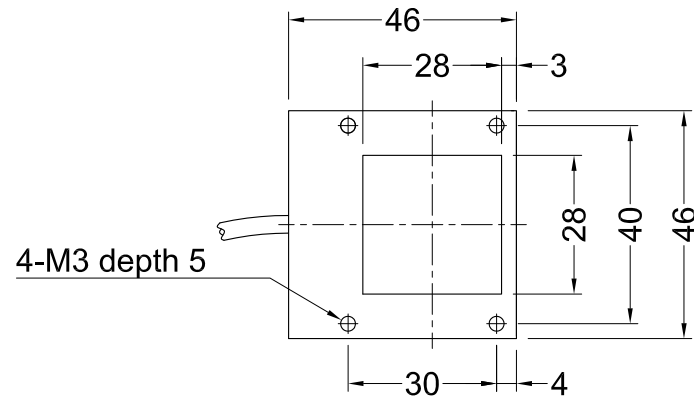

M12 Connector

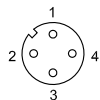

Pin 1 - +24V
 Pin 2 - Nil
 Pin 3 - 0V
 Pin 4 - Nil

Cable thickness 3.6

