

QCO-052050-47/-52/-66/-SW

Model	QCO-052050-47/-52/-SW	QCO-052050-66
Voltage	24V DC	24V DC
Power Consumption	9.3 W	7.2 W
Mass	330 g	330 g

Third Angle Projection All dimensions in mm

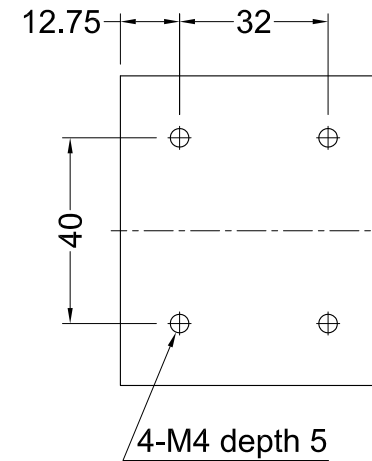
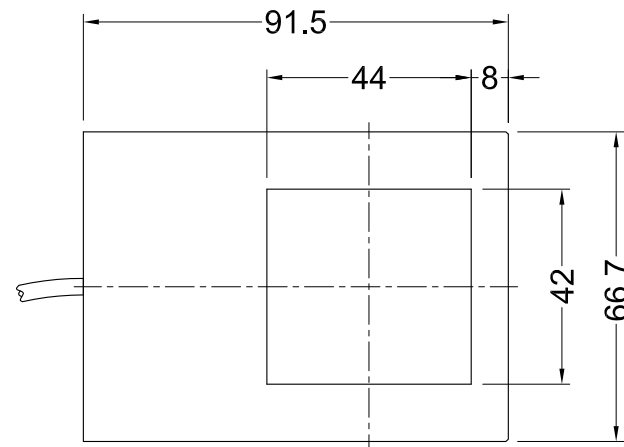

M12 Connector

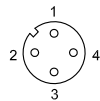

- Pin 1 - +24V
- Pin 2 - Nil
- Pin 3 - 0V
- Pin 4 - Nil

Cable thickness 3.6

